

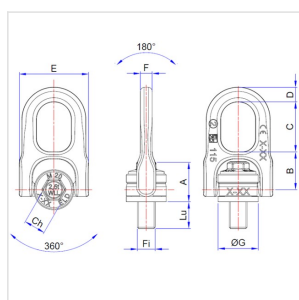

Anschlagpunkt ELD

allseitig belastbar



Art-Nr.	Typ	Tragkraft*	Masse in mm									Preis exkl. MwSt. (D) per Stk.
			kg	Lu	Ch	A	B	C	D	E	F	
067.120.030	ELD-M8	300.0	15.0	17.0	31.5	32.0	40.0	11.0	54.0	9.0	30.0	45.00
067.120.060	ELD-M10	600.0	17.0	17.0	31.5	32.0	40.0	11.0	54.0	9.0	30.0	46.00
067.120.100	ELD-M12	1000.0	21.0	17.0	31.5	32.0	40.0	11.0	54.0	9.0	30.0	47.00
067.120.160	ELD-M16	1600.0	27.0	22.0	45.0	42.5	56.0	16.5	78.0	13.3	45.0	57.00
067.120.250	ELD-M20	2500.0	30.0	22.0	45.0	42.5	56.0	16.5	78.0	13.3	45.0	59.00
067.120.400	ELD-M24	4000.0	36.0	32.0	60.5	59.0	85.0	25.0	119.0	20.0	60.0	98.00
067.120.630	ELD-M30	6300.0	42.0	32.0	60.5	59.0	85.0	25.0	119.0	20.0	60.0	103.00

